

PROVINCIAL SUBDIVISION
FILE NO.
F-44-90-04

DEPARTMENT OF MUNICIPAL AFFAIRS
THIS FINAL PLAN OF SUBDIVISION IS APPROVED FOR LOTS 1-10
DATE: **SEP 4 1990**

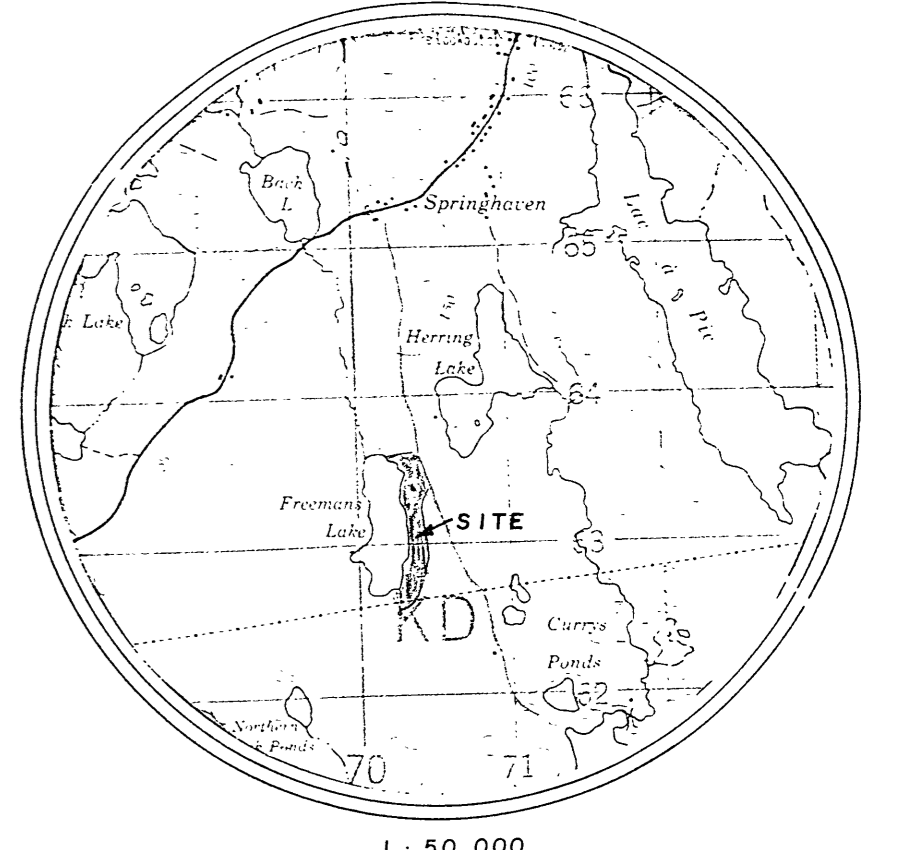

CLASS C LOT (27' 9") IN EXCESS OF 10000 SQUARE FEET AND HAVE A LOT WIDTH OF 230 FEET OR MORE. PURSUANT TO SECTION 203 OF THE REGULATION RESPECTING SUBDIVISIONS OF LAND TO BE ASSIGNED BY ON-SITE SEWERAGE SYSTEMS, THIS LOT WAS NOT ASSIGNED FOR INSTALLATION OF AN ON-SITE SEWERAGE SYSTEM AND WILL ACCORDINGLY REQUIRE AN ASSESSMENT AND APPROVAL BY THE DEPARTMENT OF HEALTH PRIOR TO ANY DEVELOPMENT UNDER THIS LOT.

WHEREAS IT IS PROVIDED THAT THE PHYSICAL CONDITIONS OF THE LOT AND THE ADJOINING PROPERTIES SHALL NOT CHANGE UNTIL THE INSTALLATION OF AN ON-SITE SEWERAGE DISPOSAL SYSTEM FOR ...
SUBJECT TO THE CONDITIONS REFERRED TO BELOW:

SANDFILL MODIFICATIONS REQUIRED

PUBLIC ROADS.
THE FOLLOWING STREETS AND HIGHWAYS ARE OWNED AND MAINTAINED BY THE DEPARTMENT OF TRANSPORTATION:
HIGHWAY # 581

Pursuant to Section 19(3) and (4) of the Planning Act, the Province shall not expend any money on a street or road that is not owned and maintained by the Province which is shown on a plan of subdivision prepared on or after the first day of August, 1987 and they are constructed in accordance with specifications issued from time to time by the Department of Transportation.

The following roads are private roads and are not owned by the Department of Transportation and are not subject to any provincial services including grading, clearing, snow plowing, graveling, and school buses.

FREEMAN LAKE DRIVE

MAGNETIC NORTH 1979



REMAINING LANDS OF 2012678 NOVA SCOTIA LTD.

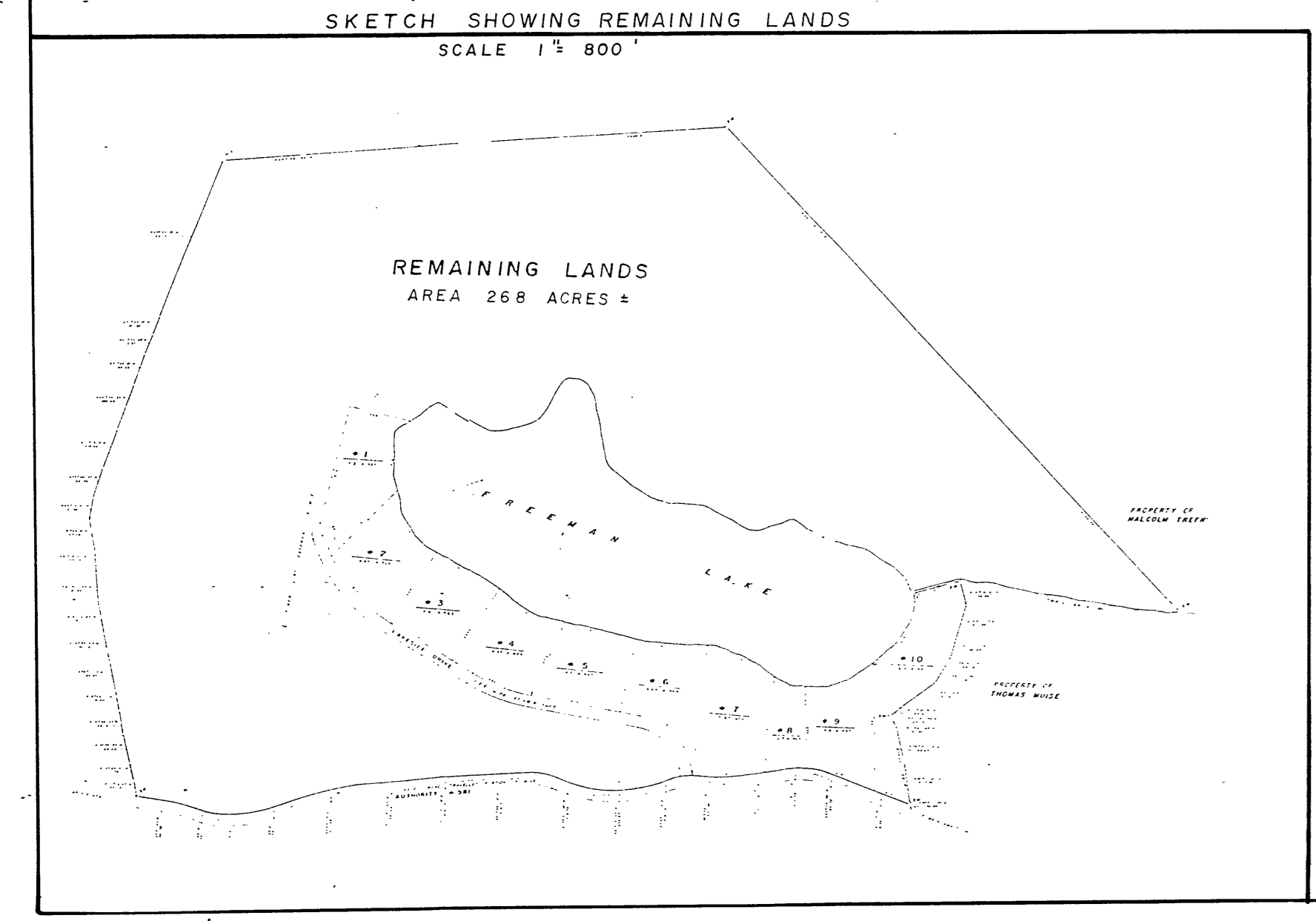

F R E E M A N L A K E

LANDS OF THOMAS MUISE

HIGHWAY # 581

REVISIONS
1. REVISED CURVE AT BEGINNING OF FREEMAN LAKE DRIVE, JULY 18/1990

#2957

SEP 4 1990

Surveyor's Certificate
I, **ROBERT L. HUNT**, Nova Scotia Land Surveyor, hereby certify that the survey represented by this plan was conducted under my supervision, and that the survey and plan were made in accordance with the Nova Scotia Land Surveyors Act and the regulations made thereunder.
Dated this 16th day of JULY 1990.
N.S.L.S.

LEGEND
— BOUNDARY LINE
--- ADJOINING BOUNDARY
- - - TRAVERSE LINE
S.M. - (SURVEY MARKER) IRON BOLT WITH ALUMINUM CAP
I.B. - IRON BOLT
I.P. - IRON PIPE
P.C.S. - POST AND STONES
N.S.C.M. - NOVA SCOTIA CONTROL MONUMENT

NOTES
1. THIS SURVEY WAS CARRIED OUT DURING THE PERIOD OF JULY 318 TO JULY 11 1990.
2. ALL BEARINGS ARE MAGNETIC
3. ALL BEARINGS & DISTANCES ARE UNADJUSTED

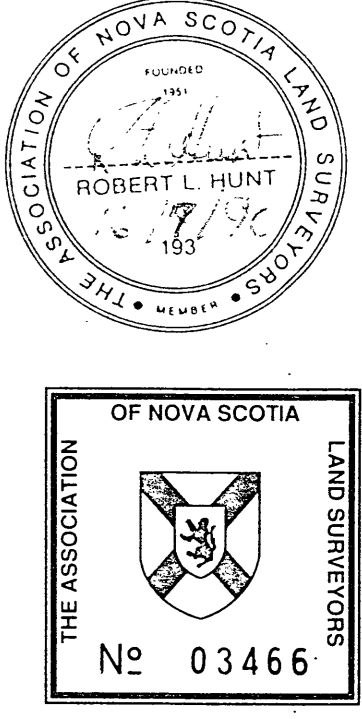

ROBERT L. HUNT
NOVA SCOTIA LAND SURVEYOR
P.O. Box 1118 Liverpool, Queens Co, Nova Scotia

"FINAL" PLAN OF SUBDIVISION OF LANDS OF 2012678 NOVA SCOTIA LTD.

LOCATION SPRINGHAVEN, YARMOUTH COUNTY NOVA SCOTIA
SCALE 1" = 100' DRAWN JULY 12-16/1990
PLOTTED BY W.M.W. DRAWN BY W.M.WENTZELL
SURVEYED BY **R.L. Hunt, N.S.L.S., #193** PLAN NO. **D-140**